

System Model	ES-20-320	
System Performance	Metric	British
Rated Random/Sine Force	20 kN	4400 lbf
Rated Shock Force	40/60* kN	8800/13200* lbf
Usable Frequency	5-3000 Hz	5-3000 Hz
Maximum Velocity	2/2.5* m/s	78.7/98.4* in/s
Maximum Acceleration	1000 m/s ²	100 g
Maximum Payload	300 kg	660 lbs
Resonance Frequency	2600±5% Hz	2600±5% Hz
Maximum Displacement p-p	51 mm	2 in
Shaker Model	ET-20	
Mass of Moving Elements	20 kg	44 lbs
Armature Diameter	320 mm	12.6 in
Weight	About 1695 kg	About 3736 lbs
Body Suspension Natural Frequency	2.5 Hz	2.5 Hz
Dimension L×W×H	1182×758×1052 mm	46.5×29.8×41.4 in
Power Amplifier Model	DA-20	
Power	20 kVA	20 kVA
Weight	About 450 kg	About 992 lbs
Power Supply Requirement	42 kVA	42 kVA
Dimension L×W×H	545×840×1750 mm	21.5×33×69 in
Cooling Type	Air Cooling	
Blower Model	B-2000LN	
Power	7.5 kW	10.06 hp
Air Flow	0.71 m ³ /s	710 l/s
Air Pressure	3.5 kPa	0.508 psi
Weight	140 kg	309 lbs

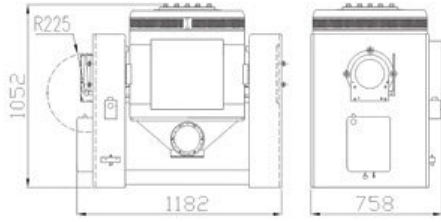

Shaker ET-20-320

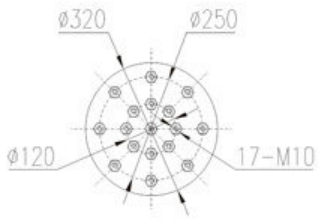

Power Amplifier DA-20

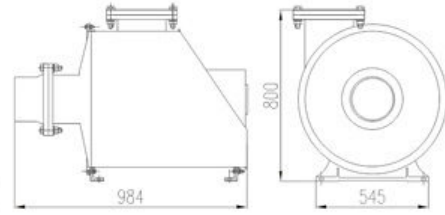

Blower B-2000LN